

Type BFS-20-O / BFS-20-OL

for liquids from 30 up to 600 cSt with optical display

Features

viscosity compensated from 30 to 600 cSt,
set point continuously adjustable,
rugged, low hysteresis, any mounting position,
high accuracy and functional safety,
with 1/2" connection also available as low cost version

Measuring ranges

0,1 ... 0,8 l/min to 30 ... 90 l/min for liquids up from
30 to 600 cSt.

Applications

Measuring and monitoring of liquids, e. g. in cooling or
hydraulic systems, test beds, pumps etc.



02 / 05 FLS US 01/1

Technical data BFS-20-O (with indication)

Measuring principle : variable aera flow meter			
Materials	brass version	stainless steel vers.	
Flow meter	: brass, nickel-plated	1.4571	
Spring	: 1.4571	1.4571	
Fitting	: brass, nickel-plated	1.4571	
Display housing	: alumin., anodized	alumin., anodized	
Glass	: Duran 50	Duran 50	
Magnets	: ferrite	ferrite	
Operating pressure	brass	VA	press. drop
BFS-20-O	: PN 10 bar	10 bar	0,02...0,4 bar
Operating temperat. : 120 °C (standard), 160 °C (option HT)			

Technical data BFS-20-OL (with indication)

Measuring principle : variable aera flow meter			
Materials	brass version	stainless steel vers.	
Flow meter	: brass, nickel-plated	1.4571	
Spring	: 1.4571	1.4571	
Fitting	: brass, nickel-plated	1.4571	
Display housing	: alumin., anodized	alumin., anodized	
Glass	: Duran 50	Duran 50	
Magnets	: ferrite	ferrite	
Operating pressure	brass	VA	press. drop
BFS-20-OL	: PN 16 bar	16 bar	0,2...0,4 bar
Operating temperat. : 120 °C (standard), 160 °C (option HT)			

Switch. ranges for:	Liquid. in l/min	Process connections
BFS-20-O:	0,1...0,8	G1/4, G1/2, G3/4, G1
	0,5...1,5	
	1,0... 4,0	
	2,0...8,0	G1/2, G3/4, G1
	3,0...10	
	5,0...15	
	8,0...24	
	10...30	G3/4, G1
	15...45	
	20...60	
30 ..90		

Switch. ranges for:	Liquid. in l/min	Process connection
BFS-20-OL:	0,5...1,7	G1/2
	1,3...4,0	
	2,5...8,0	

Accuracy	: ±10% f. s.
Electrical connect.	: plug acc. to DIN 43650
Contact rating	
BFS-20-O G1	: 250 V / 3 A / 100 VA (NO) 250 V / 1,5 A / 50 VA (SPDT)
EEx-m II T6 vers.	: 250 V / 2 A / 60 VA (NO) G1 only 250 V / 1 A / 30 VA (SPDT) G1 only
ExII 1GD	
EEx ia II B T6 vers.	: 45 V / 1 A / (NO / SPDT) G1 only
Protection class	: IP65 (plug acc. to DIN 43650) IP67 (with moulded cable, EEx-models only)

Accuracy	: ±10% f. s.
Electrical connect.	: plug acc. to DIN 43650
Contact rating	
BFS-20-OL G1	: 250 V / 3 A / 100 VA (NO) 250 V / 1,5 A / 50 VA (SPDT)
EEx-m II T6 vers.	: 250 V / 2 A / 60 VA (NO) G1 only 250 V / 1 A / 30 VA (SPDT) G1 only
ExII 1GD	
EEx ia II B T6 vers.	: 45 V / 1 A / (NO / SPDT) G1 only
Protection class	: IP65 (plug acc. to DIN 43650) IP67 (with moulded cable, EEx-models only)

Barksdale Flow Switches Overview

Specifications are subject to changes without notice.

Type BFS-20-O / BFS-20-OL

02 / 05 FLS US 01/1

Barksdale Flow Switches Overview

Specifications are subject to changes without notice.

Dimensions (in mm)

BFS-20-O

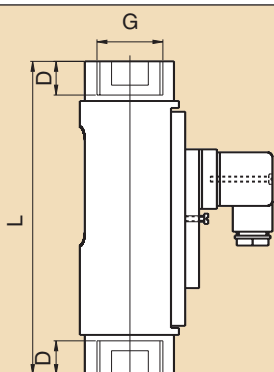

BFS-20-OL

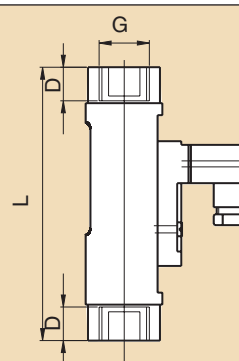

Wiring diagram

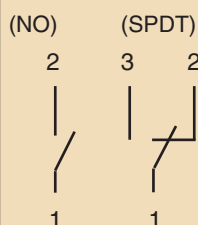

(G)	G 1/4	G 1/2	G 3/4	G 1
(hex)	41	41	41	41
(Ø)	50	50	50	50
(W)	77	77	77	77
(D)	17	17	17	17
(L)	145	145	139	158
Weight (g)	850	850	850	850

(G)	G 1/2
(hex)	27
(Ø)	32
(W)	53
(D)	14
(L)	114
Weight (g)	300

Order numbers

BFS-20	Brass	BFS-20	Brass
0712-262	BFS-20-OL-G1/2-MS-NO-ST	0712-344	BFS-20-OL-G1/2-MS-WE-ST
0712-263	BFS-20-O-G1-MS-NO-ST	0712-345	BFS-20-O-G1-MS-WE-ST
	Stainless steel		Stainless steel
0712-264	BFS-20-OL-G1/2-SS-NO-ST	0712-346	BFS-20-OL-G1/2-SS-WE-ST
0712-265	BFS-20-O-G1-SS-NO-ST	0712-347	BFS-20-O-G1-SS-WE-ST

The version BFS-20-O is also available with process connections, please see table on page P5.
To place an order please add the process connection to the order number.

Order number example: Order number + switching range = 0712-262, 1,0...4,0 l/min

Description

NO = normally open	O = with indication	MS = brass	Please specify switching range (see table on page P5) additional to order number.
WE = change-over	OL = with indication, low cost	SS = stainless steel	